



SP-MPB (STRAIGHT RUNNING)



Flat top



Flush grid 18 % open

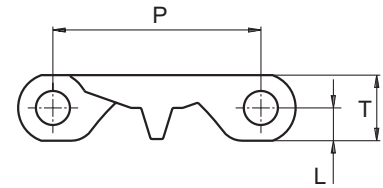

Flush grid 23 % open

Description	mm	inch
Pitch (P)	50.8	2
L	8	0.31
T	16	0.63
Backflex radius	65	2.6
Rod (∅)	8	0.31
Surface type	Flat / Open	
Color	○ ●	
Curve	No	

ACCESSORIES



Cleat height - 2", 3", 4" Scoop cleat height - 4" Side guard - 3", 4"

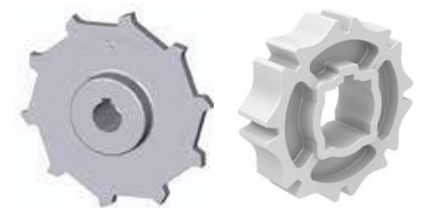

Single direction

Dual direction

SP-MPB (SPROCKET)

Teeth (Z)	Single direction						Dual direction				
	Pcd (mm)	B	M/C		M/D		Pcd (mm)	B	M/C		
			S	W	S	W			S	W	
6	101.6	36	★	40			102	42	★	40	
8	132.8	53.3	★	40			132	57	★	40	
10	164.4	70.2	★	40	■	40	42	165	72	★	40
12	196.3	86.8	★	40				196	88	★	40
16	260.4	119.7	★	40				262	121	★	40

* Type of bore : ★ - round & square, ■ - square, ● - round

* A - minimal distance 53 mm (2.1")

* For material availability contact our sales team

* M/C - Machined solid, M/D - Moulded solid, S - Availability, W - Sprocket Width

